

**5290 Arapahoe Ave.  
Units K+L  
Boulder, CO**

**11,000 Square Feet**

## Office or Retail Space Available!

- Recently finished space located within Greenwood Plaza
- Easy access and excellent visibility from Arapahoe Avenue
- High traffic count of up to 28,400 VPD
- Open floorplan
- Restroom in-suite
- Full kitchen
- Monument signage available on Arapahoe Avenue
- Great store frontage
- Abundant well-lit parking in front and rear
- Located near the hospital and major business parks in East Boulder



**TEBO**  
PROPERTIES

Contact us for more information:

[leasing@teboproperties.com](mailto:leasing@teboproperties.com)

303-447-8326

[www.TEBOproperties.com](http://www.TEBOproperties.com)

# OFFICE/RETAIL SPACE FOR LEASE

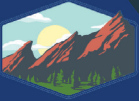

**TEBO**  
PROPERTIES

## 5290 Arapahoe Ave., Units K+L

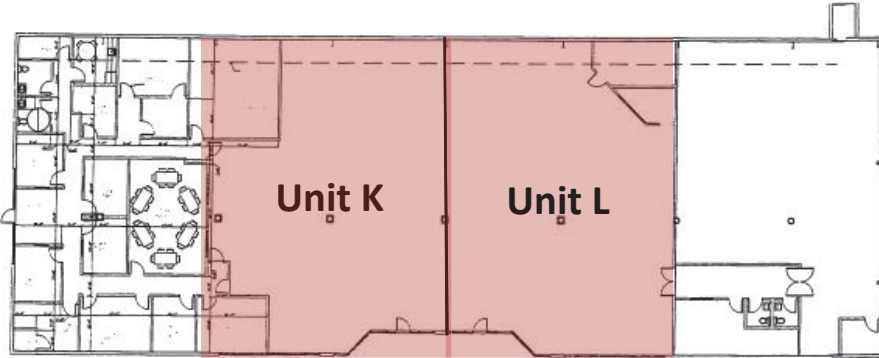

 - Available for Lease



Unit	Square Footage	Price
K+L	11,000	\$9.75/SF + \$6.44 (NNN) = \$14,840.83/MO

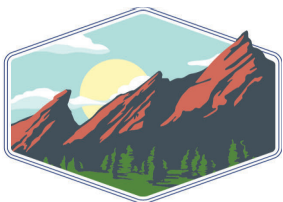

**TEBO**  
PROPERTIES

Contact us for more information:  
[leasing@teboproperties.com](mailto:leasing@teboproperties.com)  
303-447-8326  
[www.TEBOproperties.com](http://www.TEBOproperties.com)