

2950 Colorful Avenue  
Unit 500  
Longmont, CO

34,270 SF Available

## Manufacturing/Office/ Flex Space Available!

- Fully Sprinklered
- Office and lab space
- Abundant parking
- Beautiful views of the Rockies
- Amenities include locker room, bike racks, and volleyball court
- Building signage available
- Pivotal location 5 minutes east of Longmont provides easy access to Longmont, Boulder, and Denver
- Adjacent to Smucker's, UC Hospital and Walmart Supercenter
- Easy access from Interstate-25, only 5 minutes by car or truck!



**TEBO**  
PROPERTIES

Contact us for more information:

[leasing@teboproperties.com](mailto:leasing@teboproperties.com)

303-447-8326

[www.TEBOproperties.com](http://www.TEBOproperties.com)

# FLEX/OFFICE SPACE FOR LEASE



**TEBO**  
PROPERTIES

## 2950 Colorful Avenue, Suite 500

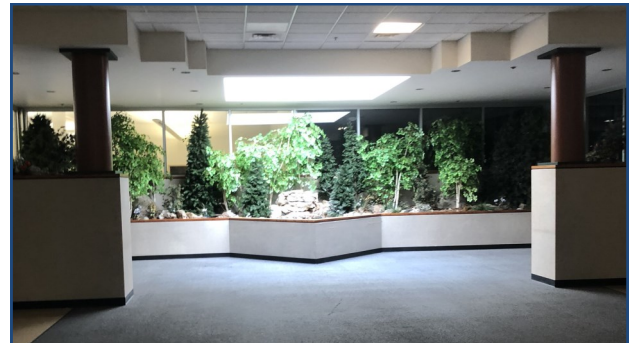
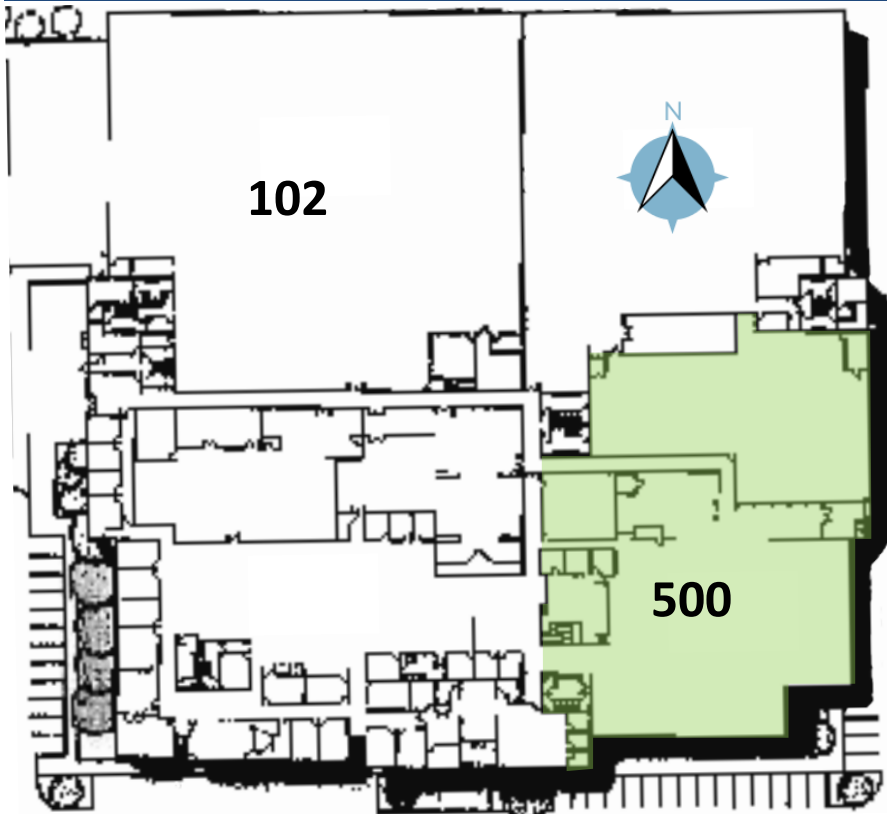

 - Available for Lease

Unit	Square Footage	Price
500	34,270	\$7.75/SF + \$4.62 (NNN) Totally Finished

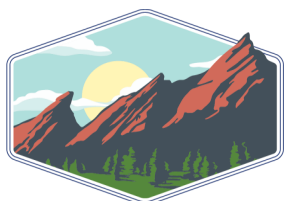

**TEBO**  
PROPERTIES

Contact us for more information:  
[leasing@teboproperties.com](mailto:leasing@teboproperties.com)  
303-447-8326  
[www.TEBOproperties.com](http://www.TEBOproperties.com)