

1655 28th Street  
Boulder, CO

1,060 Square Feet

## Fitness/Retail Space For Lease!

- Space on 28th Street can be used for Fitness or Retail
- Open Floorplan with Large Windows for Natural Light
- Across from 29th Street Mall
- Adjacent to Arapahoe Avenue & 28th Street Intersection
- Easy Access from 28th Street
- Signage on Rear of Center for Maximum Customer Exposure
- Other Tenants: Qdoba, Edible Arrangements, Golden Sun
- Ample employee and customer parking around the entire plaza
- Open Floorplan offers creativity liberties with potential new construction design



**TEBO**  
PROPERTIES

Contact us for more information:  
[leasing@teboproperties.com](mailto:leasing@teboproperties.com)  
303-447-8326  
[www.TEBOproperties.com](http://www.TEBOproperties.com)

# FITNESS/RETAIL SPACE FOR LEASE



**TEBO**  
PROPERTIES

## 1655 28th Street, Boulder CO

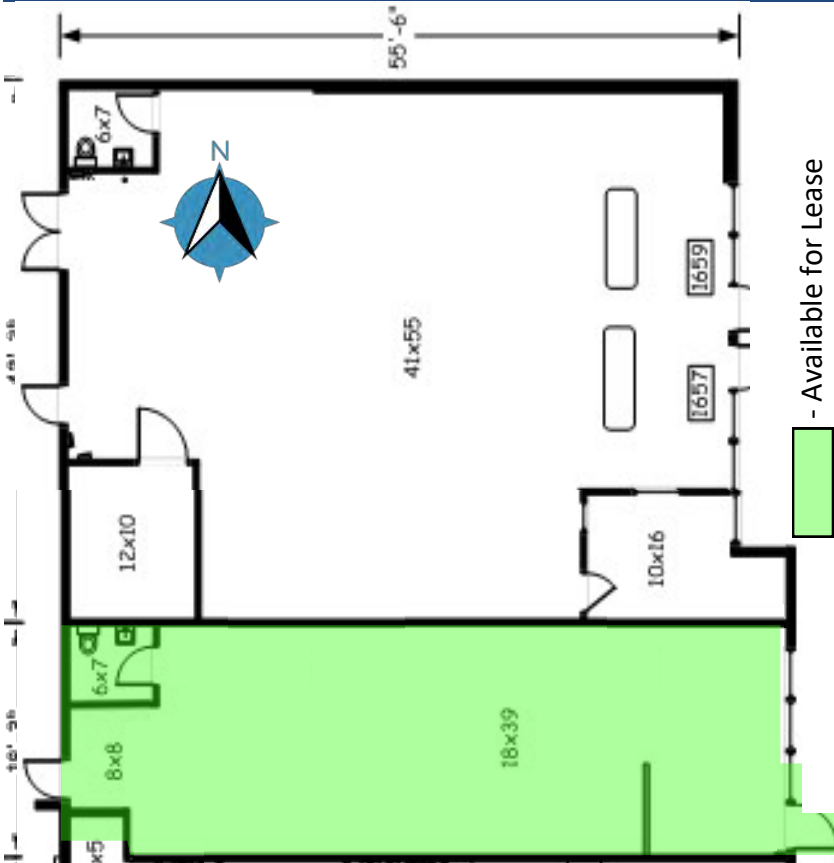
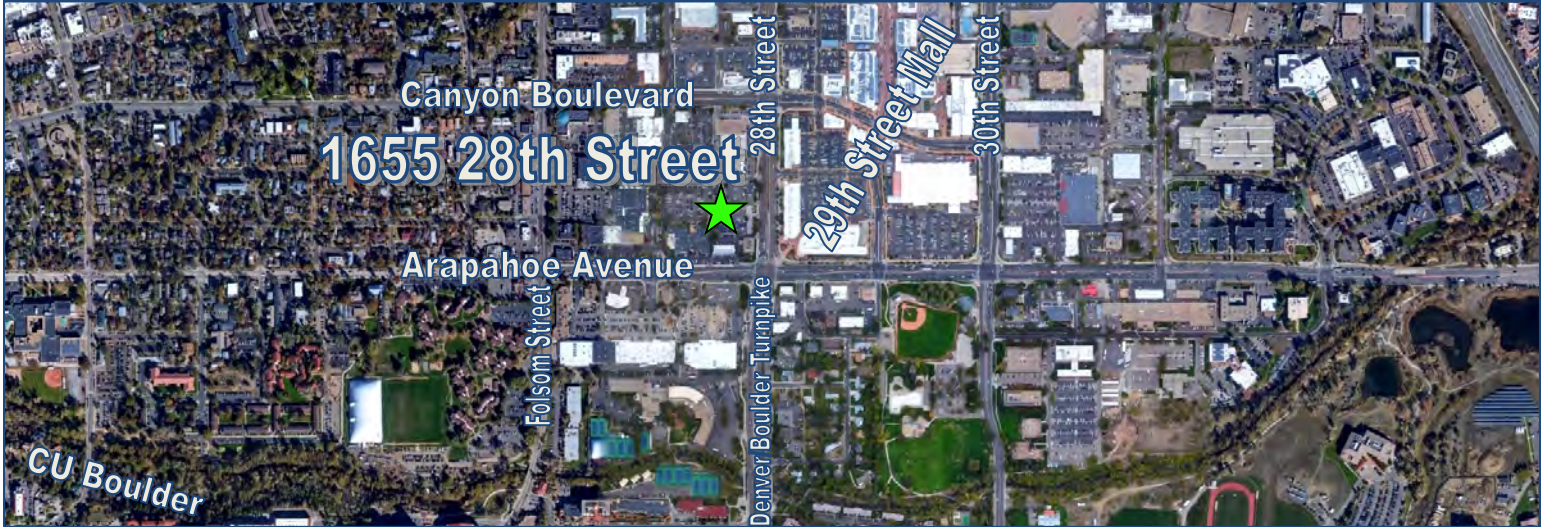

Unit	Square Footage	Price
1655	1,060	\$32.50/SF + \$12.42(NNN) = \$3,967.93/MO



**TEBO**  
PROPERTIES

Contact us for more information:  
[leasing@teboproperties.com](mailto:leasing@teboproperties.com)  
 303-447-8326  
[www.TEBOproperties.com](http://www.TEBOproperties.com)