

1209 Pearl Street Suites  
Suites 8 & 9  
Boulder, CO

209 - 307 SF  
UPSTAIRS OFFICE SUITES

### Office Space Available!

- Prime location with entrance on the Pearl Street Mall
- Large windows provide ample natural light
- Office suites located on the second floor above Lush and Helly Hansen
- Common area amenities include a shared bathroom and kitchenette
- Tiptoe to cafés, bars, shops, and more
- High pedestrian traffic area with over 125,000 visitors per week
- Close to RTD bus station
- Reserved parking available nearby



**TEBO**  
PROPERTIES

Contact us for more information:  
[leasing@teboproperties.com](mailto:leasing@teboproperties.com)  
303-447-8326  
[www.TEBOproperties.com](http://www.TEBOproperties.com)

# OFFICE SPACE FOR LEASE

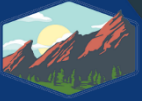

**TEBO**  
PROPERTIES

1209 Pearl Street, Suites 8 & 9

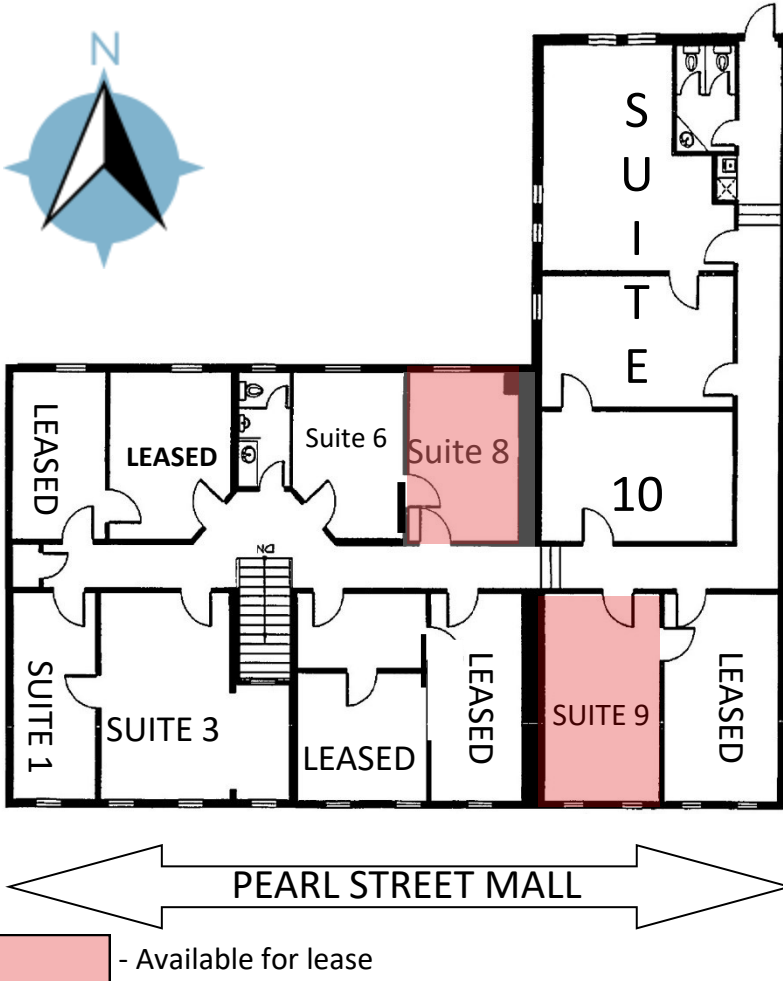

Unit	Square Footage	Price
8	209	\$750.00/MO + Utilities
9	307	\$1,250.00/MO + Utilities

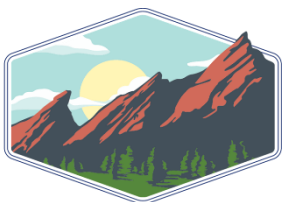

**TEBO**  
PROPERTIES

Contact us for more information:  
[leasing@teboproperties.com](mailto:leasing@teboproperties.com)  
303-447-8326  
[www.TEBOproperties.com](http://www.TEBOproperties.com)